

FLOW RESTRICTORS



Capillary

Capillary flow restrictors are designed to create back pressure on the membrane so the reverse osmosis process can occur.

Capillary flow restrictors easily insert into standard 1/4" tubing located on the membrane waste line (concentrate line) of domestic reverse osmosis systems.

The length and internal diameter of the capillary line determines the flow restriction, shorter lengths and smaller IDs allow water to pass through at a higher rate.

* You can run your unit with a smaller sized flow restrictor than indicated but if you run the unit too lean both product water quality and membrane life can be adversely affected.

** Not recommended for use with quick connect fittings

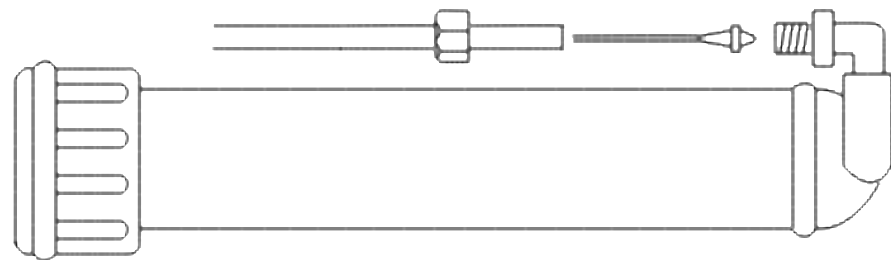

SPECIFICATIONS

Based on 4:1 waste ratio
(Convert gpd to ml/min x 4)

MEMBRANE	COLOUR	ML/MIN
10 gpd	Red	105
18 gpd	Brown	189
25 gpd	Black	263
35 gpd	Yellow	368
50 gpd	Green	525
60 gpd	Blue	631
100 gpd	White	1052

FEATURES

- Delrin Material for increased strength
- Compatible with quick connect and compression fittings
- Unique design prevents clogging
 - Easy installation
 - Fits standard 1/4" tubing

FLOW RESTRICTORS



Flushable, Payne & Elbow

Flushable flow restrictors are used to flush contaminants that may be trapped in the membrane. By flushing the membrane for a few minutes every few months you can potentially prolong the life and performance of the membrane.

When the lever is across the restrictor, the flow restrictor is active and putting back pressure on the membrane to produce pure water.

When the lever is in-line with the restrictor, water bypasses the flow restrictor and is allowed to flow at the full rate to flush the membrane.

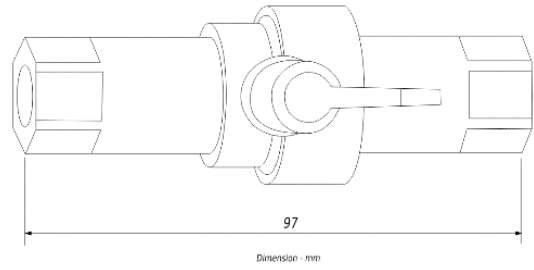

SPECIFICATIONS

ML/MIN	200 or 400
Connection	1/4" M NPT
Max operating pressure	120 psi
Max temperature	38°C (100°F)
Material	POM

WaterMark Component
(# 509/P & #510 only)

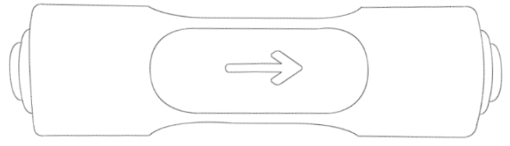
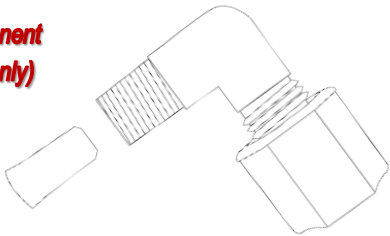

SPECIFICATIONS

Jaco Style Elbow	
Connection	1/4" Tube x 1/8" M
Max Operating Pressure	100 psi (8.8 kg/cm ²)
Working Temperature	41 - 104°F (5 - 40°C)

MATERIAL

Body	Nylon 66
Restrictor Shell	POM
Restrictor	Ceramic Ball

SPECIFICATIONS

Payne Type	
Connection	1/4"
Max Operating Pressure	100 psi (8.8 kg/cm ²)
Working Temperature	41 - 104°F (5 - 40°C)
Material	ABS

