

960 REPLACEMENT PARTS



SPECIFICATIONS

Flow rate	3 lpm
Max pressure	100 psi
Max temperature	50°C

FEATURES

160 – 5mic Sediment

- Reduces sand, dirt & sediment

161 – 5mic GAC

- Chlorine, taste & odour reduction
- Coconut shell carbon

162 – 10mic Carbon Block

- Chlorine, taste & odour reduction



160

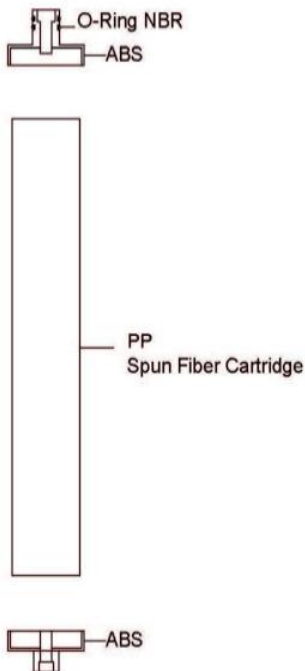

161

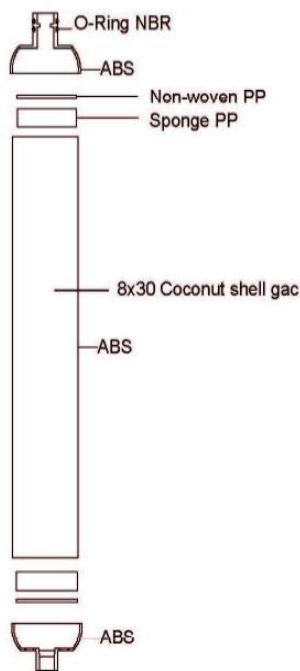

162

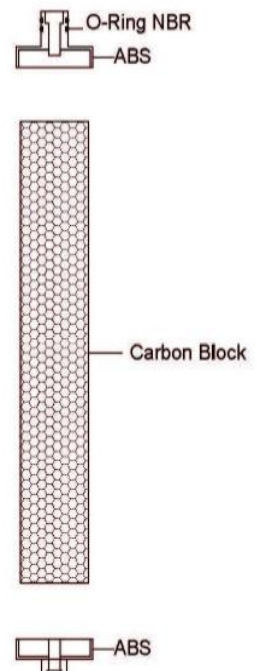

WARNING:
Do not use water that is microbiologically unsafe or of unknown quality without adequate disinfection.

AQUA PRO

CrystalClear
PURIFICATION SYSTEMS PTY LTD

960 REPLACEMENT PARTS



SPECIFICATIONS

Max pressure	100 psi
Max temperature	50°C
In/Out	1/4" QC



WaterMark Component
 (#162/HS & #162/MH only)

Housings, membrane housings, opening handles and replacement caps available.

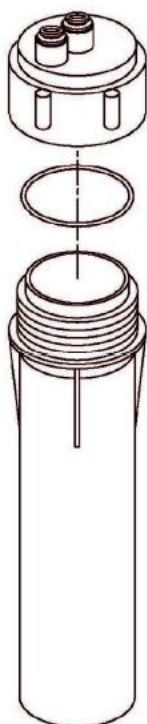

- CAP-ABS
- O-RING-NBR
- SUMP-PP

162/HS

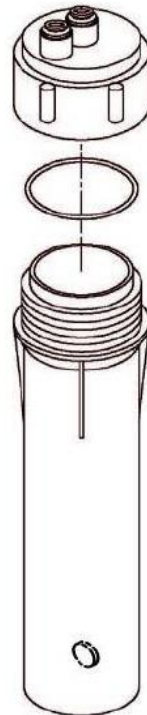

- CAP-ABS
- O-RING-NBR
- SUMP-PP

162/MH

WARNING:
 Do not use water that is microbiologically unsafe or of unknown quality without adequate disinfection.

